

Á Á Á  
Á

## ARISTON ABS PRO PLUS PW

ARISTON ABS PRO PLUS PW

370 0180		ABS PRO PLUS PW 50 V	...	...
370 0181		ABS PRO PLUS PW 80 V	...	...
370 0182		ABS PRO PLUS PW 100 V	...	...
Reference	Ind.	Model type	Begin	End

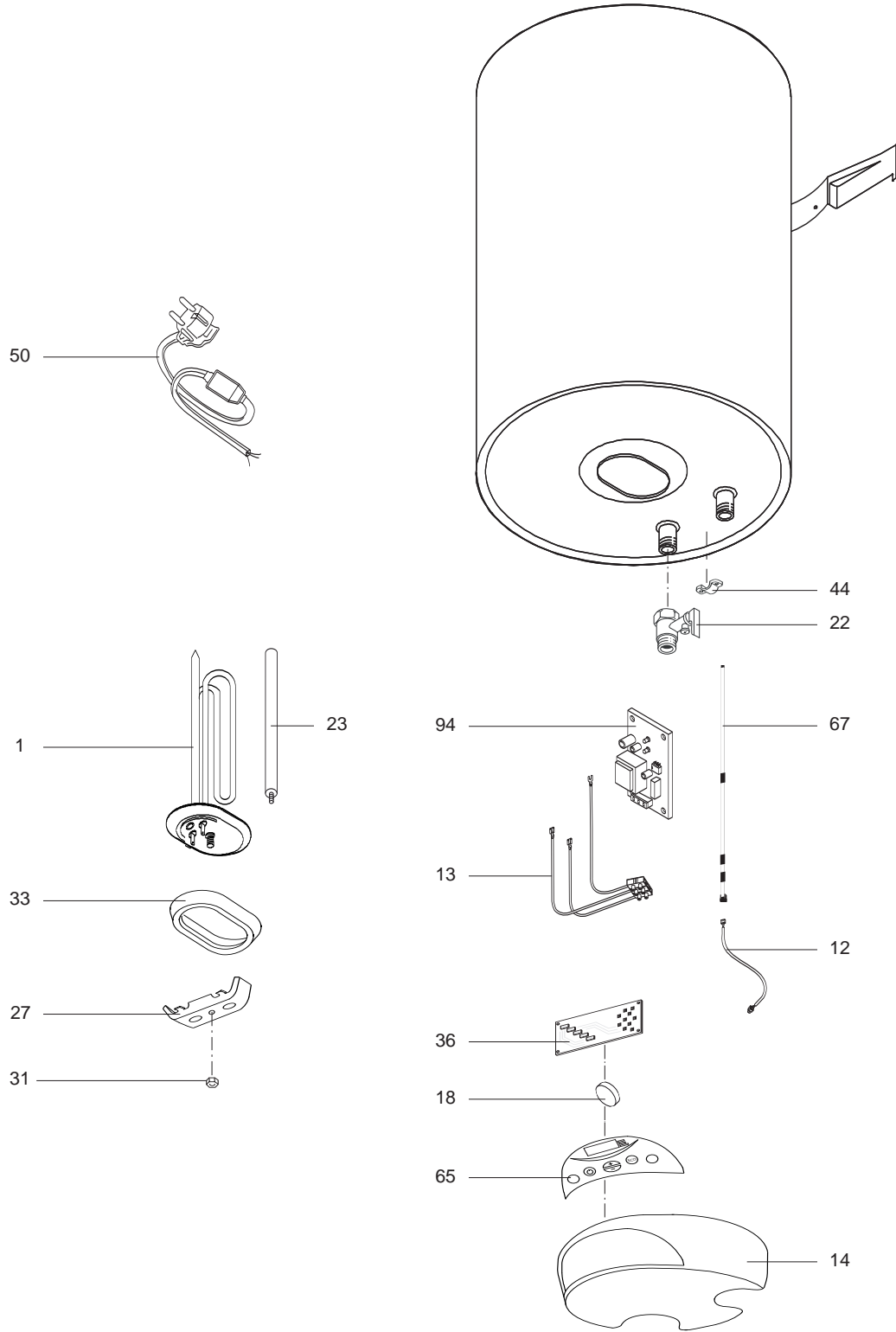

Key№ / Поз-я №	Description	Наименование	Code / Код	Type / Тип	50V	80V	100V	From / Начиная с	To / До
	<b>04_12_2008</b>	<b>R8216308-01EN - Edition 01</b>							
0001	HEATING ELEMENT 1000/1500W 230V	ТЭН 1000/1500Вт / 230В	65150909		*	*	*		
0012	WIRING (PROBE)	Проводка (для датчика температуры)	65102590		*	*	*		
0013	WIRING P.C.B.	Проводка (плата силовых цепей)	65108285		*	*	*		
0014	PLASTIC COVER	Крышка пластиковая нижняя	65150962		*	*	*		
0018	KNOB	Ручка	65150963		*	*	*		
0022	SAFETY VALVE WITH LEVER	Предохранительный клапан	571730		*	*	*		
0023	ANODE D:25,5 L:230 M5	Магниевый анод D:25,5 L:230 M5	993014		*	*	*		
0027	FLANGE BRACKET	Фиксатор фланца	65180035		*	*	*		
0031	HEXAGONAL NUT	Гайка	570127		*	*	*		
0033	FLANGE GASKET	Фланец с прокладкой	570177		*	*	*		
0036	P.C.B.	Электронная плата панели управления	65150964		*	*	*		
0044	CABLE CLAMP	Кабельный зажим	573266		*	*	*		
0050	POWER CABLE WITH ELCB	Электрический кабель с УЗО	65150965		*	*	*		
0065	DISPLAY	Дисплей	65150961		*	*	*		
0067	SENSOR	Температурный датчик	65102543		*	*	*		
0094	P.C.B.	Электронная плата управления	65108284		*	*	*		

## LIST OF THE ABBREVIATIONS

HW .....	: Hot water.
CW .....	: Cold water.
C .....	: Ceramic resistance (normal heating).
Ca .....	: Ceramic resistance (accelerated heating)
TP .....	: Immersion heater.
1F .....	: With fittings.
2F .....	: Without fittings.
3F .....	: With fittings and another outlet connection.
AMI .....	: With mixing valve.
SMI .....	: Without mixing valve.
PUISS .....	: Power of th appliance.
PN .....	: Appliance with normal pression.
LP .....	: Appliance with low pression.
PV .....	: Appliance with variable power.
PF .....	: Appliance with fixed power..

## IDENTIFICATION PLATE

### SERIAL NUMBER

Ex: 03 09 08 (Until 12/06)

OR

Ex: 02 11 00001 007843

Ex: 3200050 XX 070115 0000001 (From 01/07)

The indications mentioned on the prices, commercial or technical literature and the scheme are written for your guidance and are available at a given time. The CONSTRUCTOR retains the power to modify the presentation, the form, the size, the conception or the material of the products.